

CUSTOM STRUT & ROLL FORMING

EMT Strut Clamps

- Material: Carbon Steel
- Available Finishes:
 - PG: Pre Galvanized
 - YZ: Yellow Zinc Dichromate
 - HDG: Post Fabrication Hot Dip Galvanization
 - PC: Powder Coat
 - SS: Stainless 304 or 316 available upon request

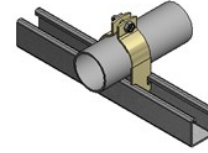

Custom Strut Part #	Description	O.D. Size In.	Parts per Box	Weight per PC. LBS.
ESC050-PG	½" EMT Strut Clamp	0.500	100	.10
ESC075-PG	¾" EMT Strut Clamp	.750	100	.16
ESC100-PG	1" EMT Strut Clamp	1	100	.18
ESC125-PG	1-1/4" EMT Strut Clamp	1.250	50	.20
ESC150-PG	1-1/2" EMT Strut Clamp	1.500	50	.28
ESC200-PG	2" EMT Strut Clamp	2	50	.33
ESC250-PG	2-1/2" EMT Strut Clamp	2.500	25	.37
ESC300-PG	3" EMT Strut Clamp	3	25	.40
ESC400-PG	4" EMT Strut Clamp	4	25	.61
ESC500-PG	5" EMT Strut Clamp	5	25	.99
ESC600-PG	6" EMT Strut Clamp	6	25	.99